

## Motorized Latch Release Installation

### STEP 1

Remove Latch from the vehicle and take it to a bench to work on. Measure how much travel latch release needs to release latch **(NOT THE FULL TRAVEL JUST TO RELEASE)** Write down here. =(STEP1)

### STEP 2

(Shipped with Step 2 Complete). Prepare EASYPOP for installation. Add 12volts to the Red wire and tap the green wire to ground till the EASYPOP cable is fully extended as far out as it can be. If you went too far momentarily tap green wire on ground again till its in its outmost position.

### STEP 3

Securely Attach EASYPOP Cable to Door latch used for the outside handle



### STEP 4

Align EASYPOP cable to geometry on latch that is identifiable.

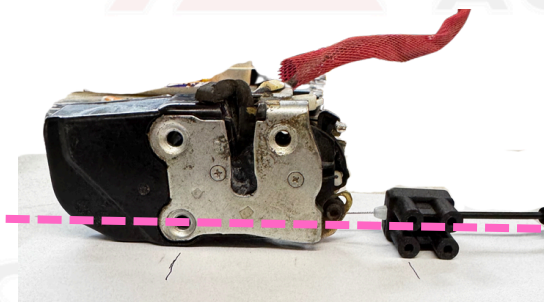

### STEP 5

Measure distance between two Identifiable mounting positions laying flat no pressure on latch this number will be Length.

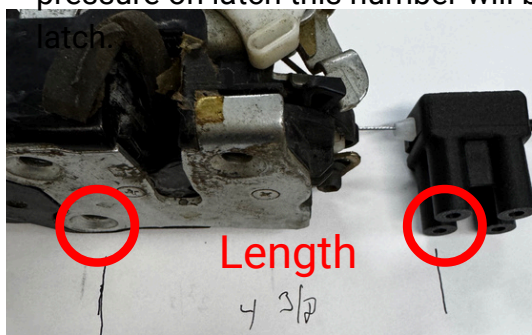

$\text{LENGTH} + (\text{STEP1}) - \frac{7}{8} = \text{correct mounting distance for Step 6}$

Example 1: Latch travel is STEP1=  $\frac{1}{2}$  "

STEP 6 Distance =  $4 \frac{3}{8} + \frac{1}{2} - \frac{7}{8} = 4 "$

Example 2: Latch travel is STEP1= 1 "

STEP 6 Distance =  $4 \frac{3}{8} + 1 - \frac{7}{8} = 4 \frac{1}{2} "$

	+		-	$\frac{7}{8} "$	=	
LENGTH		STEP1				correct mounting distance for Step 6

# EASYPOP Installation

## STEP 6

Measure distance down from Identifiable Latch point and make a mark. Crucial to get this right



## STEP 7

Measure out marking grid

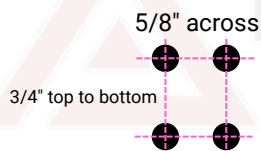

## STEP 8

Drill holes using a 3/16" drill bit. You do not need to drill all 4. 1 top and 1 bottom is sufficient.



## STEP 9

If mounting to irregular surface trim or sand off Extra length of mount to keep the cable mount as straight as possible. Cable conduit needs to leave mount parallel to the cable mount.



## STEP 10

check alignment



## STEP 11

Reinstall Latch and install cable mount with provided #8 Phillips Stainless Steel Screws. Make sure Mount shown in Step 10 is fully tight against and fully seated against the cable mount.

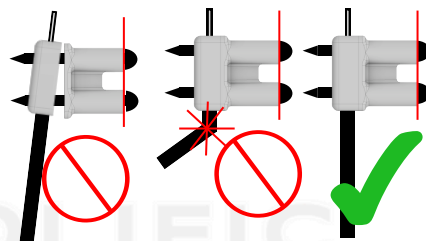



# EASYPOP Installation

## STEP 15

After confirming Step 13 latch the door, with the door open, actuate the EASYPOP using Step 14 circuit. IF Step 1-14 were done per instruction sheet it should open the latch.

**Make sure door is unlocked**

## STEP 16

If door latch opens make sure screws from step 12 are tight and move on to Step 18.

**EASYPOP has a max of 1" of travel. Most latches have less than that (1/2" is typical). If you bind the EASYPOP (ask it to pull through the latch stop) it will tear itself apart and is not covered under Warranty. EASYPOP will not lose power over time. No need to make it work harder than it needs to. Ideally we want it adjusted to just barely release the latch. This will allow the Easypop To work the most efficient.**

## STEP 17

If latch does not open at do Step 12 and move carrier 1/16" at a time away from the EASYPOP Mechanism retighten screws and test. If carrier is all the way out and still doesn't Open latch. Steps 1-11 need to be fixed.

## STEP 18

Mount EASYPOP anyway you like as long as the cable and wiring exit below cap.

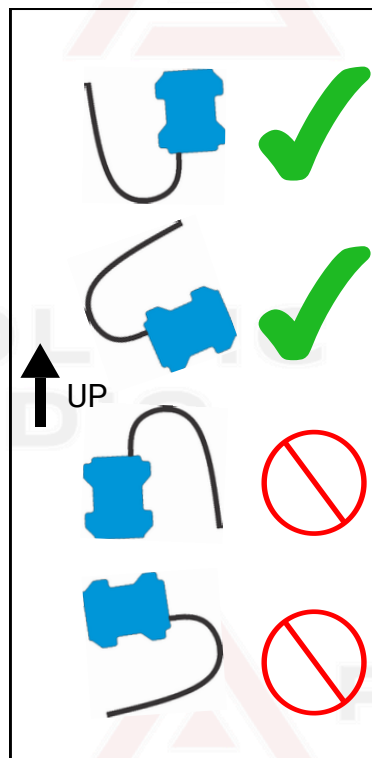

## STEP 19

Enjoy a lifetime of hassle free, maintenance free operation.

1 YEAR WARRANTY\*



2347 Old Collinsville Rd.  
Belleville, IL 62221

618.222.2281